

IMPACT WRENCHES



AIRCAT
PNEUMATIC



High Torque Performance
Innovative Vibrotherm Drive
Ergonomic and Quiet
Durability You Can Trust



AIRCAT
PNEUMATIC TOOLS

AIRCAT mechanisms - Power and Durability in Every Impact

Discover the advanced technology behind AIRCAT IMPACT WRENCHES, designed to offer maximum performance, lower vibration and long service life. Ideal for demanding tasks, our tools guarantee efficiency and reliability in any professional application.



UNBEATABLE STRENGTH

AIRCAT tools: Power, durability and innovation for demanding professionals.



VIBROTHERM DRIVE: AIRCAT's patented system that offers faster impact frequency, high torque, low vibration and greater durability. The elimination of pins and the use of a plate that retains lubrication reduce wear and extend the life of the equipment.



TWIN HAMMER: Mechanism most commonly used in AIRCAT 3/8', 1/2' and 3/4' impact models. AIRCAT MODELS. Produces two impacts per rotation, ensuring a high frequency of blows and high torque.



PIN-LESS HAMMER: Used on AIRCAT 1' impact wrenches. AIRCAT 1' impact wrenches, this robust, pin-less system offers greater reliability for heavy-duty jobs, with a large hammer that produces a strong impact per revolution hammer that produces a strong impact per rotation.

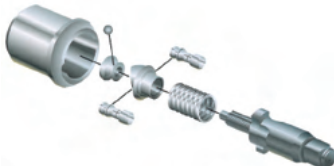

TWIN CLUTCH: Present on the NITROCAT 1/2' models, it is ideal for difficult motors and screws, providing high initial torque and high initial torque and smooth operation with rapid acceleration.



JUMBO HAMMER: Fitted to AIRCAT compact AIRCAT and NITROCAT compact models, this mechanism delivers high torque in a small size, with a powerful impact per revolution.



TWO JAW CLUTCH: Exclusive to the AIRCAT 1890-P 1' model, this mechanism eliminates the traditional impact, increasing torque and reducing wear and tear. Ideal for work, such as vehicle maintenance off-road vehicles and building steel structures.

WHEN YOU HAVE REAL WORK TO DO...
GRAB AN **AIRCAT**.

IMPACT WRENCHES 1/2"



1056-XL

1/2" COMPOSITE COMPACT IMPACT WRENCH

MAX. TORQUE (NM)	LOOSENING TORQUE (NM)	SQUARE DRIVE (IN.)	IMPACTS PER MINUTE	SPEED (RPM)	BOLT CAPACITY (MM)	WEIGHT (KG)	LENGTH (MM)	LEVEL VIBRATION (SEC2)	AIR CONS. (CFM)	REC. HOSE SIZE (IN.)
750	1016	1/2"	1650	9,000	15	1.13	107	9.9	8	3/8"



- LOW WEIGHT CONSTRUCTION
- DELIVERY MAXIMUM POWER
- 85 DBA NOISE LEVEL



TUNE-UP KIT CONTAINS SPARES NO.:
2, 3, 15, 18, 23, 27, 29, 32, 40, 45



1057-TH

1/2" | STUBBY IMPACT WRENCH

MAX. TORQUE (NM)	LOOSENING TORQUE (NM)	SQUARE DRIVE (IN.)	IMPACTS PER MINUTE	SPEED (RPM)	BOLT CAPACITY (MM)	WEIGHT (KG)	LENGTH (MM)	LEVEL VIBRATION (SEC2)	AIR CONS. (CFM)	REC. HOSE SIZE (IN.)
680	950	1/2"	1600	9,000	13	1.27	98	12.5	8	3/8"



- RELIABLE JUMBO HAMMER MECHANISM
- TRIGGER MOUNTED COMBINED FORWARD/REVERSE
- LOW WEIGHT ALUMINUM ALLOY HOUSING



TUNE-UP KIT CONTAINS SPARES NO.:
9, 14, 19, 24, 25, 28, 30, 32, 37



1058-VXL & 1059-VXL

1/2" & 3/8" | COMPACT IMPACT WRENCH

MAX. TORQUE (NM)	LOOSENING TORQUE (NM)	SQUARE DRIVE (IN.)	IMPACTS PER MINUTE	SPEED (RPM)	BOLT CAPACITY (MM)	WEIGHT (KG)	LENGTH (MM)	LEVEL VIBRATION (SEC2)	AIR CONS. (CFM)	REC. HOSE SIZE (IN.)
750	1016	1/2" & 3/8"	1700	9,000	15	1.27	111	4.3	8	3/8"



- NEW MECHANISM CUTS VIBRATIONS BY 30%-40%
- VIBROTHERM DRIVE TECHNOLOGY
- PATENTED GRIP ENSURES AIRCAT'S COMFORT



TUNE-UP KIT CONTAINS SPARES NO.:
4B, 6, 12, 19, 20, 22, 26, 28, 30, 32, 33, 36, 41, 42, 43B



NEW

1070

1/2" | GEARLESS AIR ANGLE IMPACT WRENCH

MAX. TORQUE (NM)	LOOSENING TORQUE (NM)	SQUARE DRIVE (IN.)	IMPACTS PER MINUTE	SPEED (RPM)	BOLT CAPACITY (MM)	WEIGHT (KG)	LENGTH (MM)	SOUND PRESSUR (DB(A))	AIR CONS. (CFM)	REC. HOSE SIZE (IN.)
540	680	1/2"	1600	9,500	15	1.45	241	91	4.2	3/8"



- 360° ROTATIONAL EXHAUST
- FEATHER TRIGGER
- JUMBO HAMMER MECHANISM



TUNE-UP KIT CONTAINS SPARES NO.:
4, 17, 22, 23, 24, 26, 27, 29, 30, 40, 41, 44



NEW

1125

1/2" | IMPACT WRENCH

MAX. TORQUE (NM)	LOOSENING TORQUE (NM)	SQUARE DRIVE (IN.)	IMPACTS PER MINUTE	SPEED (RPM)	BOLT CAPACITY (MM)	WEIGHT (KG)	LENGTH (MM)	LEVEL VIBRATION (SEC2)	AIR CONS. (CFM)	REC. HOSE SIZE (IN.)
1355	1695	1/2"	1600	8,500	19	1.72	180	8.1	8	1/4"



- SETS INDUSTRY STANDARD FOR WEIGHT & POWER
- PATENTED EASY FLIP LEVER
- DURABLE COMPOSITE HOUSING



TUNE-UP KIT CONTAINS SPARES NO.:
2, 4, 15, 17, 20, 22, 27, 29, 32, 33, 35, 37, 42



1150 1/2" IMPACT WRENCH										
MAX. TORQUE (NM)	LOOSENING TORQUE (NM)	SQUARE DRIVE (IN.)	IMPACTS PER MINUTE	SPEED (RPM)	BOLT CAPACITY (MM)	WEIGHT (KG)	LENGTH (MM)	LEVEL VIBRATION (SEC2)	AIR CONS. (CFM)	REC. HOSE SIZE (IN.)
1250	1755	1/2"	1400	9.000	15	2.04	190	8.1	8	3/8"



- MOST POWERFUL IMPACT IN ITS CLASS 1/2"
- HARD HITTING TWIN HAMMER MECHANISM
- PATENTED ERGONOMICALLY DESIGNED HANDLE



TUNE-UP KIT CONTAINS SPARES NO.:
5, 7, 13, 16, 19, 23, 26, 32, 33, 34, 37, 39, 40, 47



1178-VXL 1/2" IMPACT WRENCH										
MAX. TORQUE (NM)	LOOSENING TORQUE (NM)	SQUARE DRIVE (IN.)	IMPACTS PER MINUTE	SPEED (RPM)	BOLT CAPACITY (MM)	WEIGHT (KG)	LENGTH (MM)	LEVEL VIBRATION (SEC2)	AIR CONS. (CFM)	REC. HOSE SIZE (IN.)
1290	1762	1/2"	1400	7.500	19	2	203	6.5	8	1/4"



- NEW MECHANISM CUTS VIBRATIONS BY 30%-40%
- PATENTED MUFFLER ENSURES LOW NOISE (86 DBA)
- PATENTED GRIP ENSURES COMFORT



TUNE-UP KIT CONTAINS SPARES NO.:
4, 6, 12, 21, 23, 26, 31, 33, 34, 37, 40, 42, 43, 44



1280-IND 1/2" COMPOSITE IMPACT WRENCH										
MAX. TORQUE (NM)	LOOSENING TORQUE (NM)	SQUARE DRIVE (IN.)	IMPACTS PER MINUTE	SPEED (RPM)	BOLT CAPACITY (MM)	WEIGHT (KG)	LENGTH (MM)	LEVEL VIBRATION (SEC2)	AIR CONS. (CFM)	REC. HOSE SIZE (IN.)
1100	1507	1/2"	1600	8.000	14.3	2.09	168	8.1	8	3/8"



- 4-POSITION POWER SWITCH AT BACK CAP
- BUILT-IN SIDE IMPACT BUFFERS
- LOW WEIGHT COMPOSITE HOUSINGS



TUNE-UP KIT CONTAINS SPARES NO.:
2, 3, 15, 16, 19, 21, 22, 27, 32, 33, 40, 46



1431 1/2" IMPACT WRENCH										
MAX. TORQUE (NM)	LOOSENING TORQUE (NM)	SQUARE DRIVE (IN.)	IMPACTS PER MINUTE	SPEED (RPM)	BOLT CAPACITY (MM)	WEIGHT (KG)	LENGTH (MM)	LEVEL VIBRATION (SEC2)	AIR CONS. (CFM)	REC. HOSE SIZE (IN.)
1080	1355	1/2"	1600	9.000	13	2.5	182	12.5	8	3/8"



- TRIPLE HEAT-TREATED STEEL PARTS ENSURE RELIABILITY
- CROSS BOLT FOR FORWARD/REVERSE AND POWER CONTROL
- ERGONOMIC GRIP FOR UNMATCHED COMFORT



TUNE-UP KIT CONTAINS SPARES NO.:
4, 8, 14, 16, 21, 22, 26, 32, 35, 37, 39



1450 & 1450-2 1/2" IMPACT WRENCH										
MAX. TORQUE (NM)	LOOSENING TORQUE (NM)	SQUARE DRIVE (IN.)	IMPACTS PER MINUTE	SPEED (RPM)	BOLT CAPACITY (MM)	WEIGHT (KG)	LENGTH (MM)	LEVEL VIBRATION (SEC2)	AIR CONS. (CFM)	REC. HOSE SIZE (IN.)
1090	1355	1/2"	1200	9.000	15	2.2	177	13.5	8	3/8"
1090	1355	1/2" x 2"	1200	9.000	15	2.3	228	14.0	8	3/8"



- VERY FAST TORQUE DEVELOPMENT
- 6-POSITION POWER SWITCH FOR ULTIMATE CONTROL
- TWIN HAMMER INCREASES EFFICIENCY



TUNE-UP KIT CONTAINS SPARES NO.:
9, 12, 16, 19, 23, 26, 28, 30, 33

WHEN YOU HAVE REAL WORK TO DO...
GRAB AN **AIRCAT**.

IMPACT WRENCHES 3/4"



1600-TH-A

3/4" | "SUPER DUTY" IMPACT WRENCH

MAX. TORQUE (NM)	LOOSENING TORQUE (NM)	SQUARE DRIVE (IN.)	IMPACTS PER MINUTE	SPEED (RPM)	BOLT CAPACITY (MM)	WEIGHT (KG)	LENGTH (MM)	LEVEL VIBRATION (SEC2)	AIR CONS. (CFM)	REC. HOSE SIZE (IN.)
1900	2169	3/4"	900	4.500	22	3.67	234	7.4	10	1/2"



- SUPER CLUTCH TWIN HAMMER MECHANISM
- IDEAL FOR BUSES, LARGE VEHICLES, AND BOLT ASSEMBLY
- IDEAL FOR GENERAL MAINTENANCE



TUNE-UP KIT CONTAINS SPARES NO.:
5, 7, 13, 16, 18, 20, 22, 23, 31, 32, 36, 38, 39



1777

3/4" | "SUPER DUTY" IMPACT WRENCH

MAX. TORQUE (NM)	LOOSENING TORQUE (NM)	SQUARE DRIVE (IN.)	IMPACTS PER MINUTE	SPEED (RPM)	BOLT CAPACITY (MM)	WEIGHT (KG)	LENGTH (MM)	LEVEL VIBRATION (SEC2)	AIR CONS. (CFM)	REC. HOSE SIZE (IN.)
1900	2305	3/4"	1600	9.000	13	3.4	97.90	12.5	60	3/8"



- TRIPLE HEAT-TREATED STEEL FOR RELIABILITY
- REFINED TWIN HAMMER BOOSTS EFFICIENCY AND LIFESPAN
- VERY FAST TORQUE DEVELOPMENT



TUNE-UP KIT CONTAINS SPARES NO.:
7, 11, 14, 15, 17, 20, 24, 25, 31, 34.



1778-VXL

3/4" | IMPACT WRENCH

MAX. TORQUE (NM)	LOOSENING TORQUE (NM)	SQUARE DRIVE (IN.)	IMPACTS PER MINUTE	SPEED (RPM)	BOLT CAPACITY (MM)	WEIGHT (KG)	LENGTH (MM)	LEVEL VIBRATION (SEC2)	AIR CONS. (CFM)	REC. HOSE SIZE (IN.)
1900	2305	3/4"	1400	7.500	19	2.9	203	6.5	8	1/4"



- PATENTED GRIP ENSURES AIRCAT® COMFORT
- NEW MECHANISM CUTS VIBRATIONS BY 30%-40%
- PATENTED MUFFLER ENSURES UNMATCHED LOW NOISE



TUNE-UP KIT CONTAINS SPARES NO.:
4, 6, 12, 21, 23, 27, 29, 31, 33, 34, 42, 43

IMPACT WRENCHES 1"



1900-A & 1900A-1

1" x 8" | EXTENDED "SUPER DUTY" IMPACT WRENCH

MAX. TORQUE (NM)	LOOSENING TORQUE (NM)	SQUARE DRIVE (IN.)	IMPACTS PER MINUTE	SPEED (RPM)	BOLT CAPACITY (MM)	WEIGHT (KG)	LENGTH (MM)	LEVEL VIBRATION (SEC2)	AIR CONS. (CFM)	REC. HOSE SIZE (IN.)
2580	2982	1"x8"	1600	5.500	32	11.7	558	12.1	12	1/2"
2580	2982	1"	1600	5.500	32	10.9	393	12.0	12	1/2"



- HARD HITTING TWIN HAMMER
- DURABLE ALUMINUM HOUSING
- RUGGED 'SUPER CLUTCH' TWIN HAMMER



TUNE-UP KIT CONTAINS SPARES NO.:
07, 14, 18, 20, 22, 23, 28



1991 & 1991-1

1" x 7" | EXTENDED IMPACT WRENCH

MAX. TORQUE (NM)	LOOSENING TORQUE (NM)	SQUARE DRIVE (IN.)	IMPACTS PER MINUTE	SPEED (RPM)	BOLT CAPACITY (MM)	WEIGHT (KG)	LENGTH (MM)	LEVEL VIBRATION (SEC2)	AIR CONS. (CFM)	REC. HOSE SIZE (IN.)
2850	3118	1"x7"	1600	6,000	32	9.38	482	8.8	8	1/2"
2850	3118	1"	1600	6,000	32	7.57	327	8.8	8	1/2"



- UNMATCHED POWER TO WEIGHT RATIO
- FRICTION-RIVVING AND THROUGH-HOLE RETAINERS COMBINED
- EXHAUST ADJUSTABLE TO TOP OR BOTTOM



TUNE-UP KIT CONTAINS SPARES NO.:
07, 17, 20, 21, 23, 40, 41



NEW

1992-A & 1992-A-1

1" X 6" | EXTENDED STRAIGHT IMPACT WRENCH

MAX. TORQUE (NM)	LOOSENING TORQUE (NM)	SQUARE DRIVE (IN.)	IMPACTS PER MINUTE	SPEED (RPM)	BOLT CAPACITY (MM)	WEIGHT (KG)	LENGTH (MM)	LEVEL VIBRATION (SEC2)	AIR CONS. (CFM)	REC. HOSE SIZE (IN.)
2169	2440	1"x6"	1600	5,000	25.4	11.5	513	9.6	12	1/2"
2169	2440	1"	1600	5,000	25.4	10.5	393	9.6	12	1/2"



- ENLARGED CAVITY IN ROTATING 'D' HANDLE
- TRIPLE-HEATED STEEL ENSURES ULTIMATE RELIABILITY
- RUBBER COVER PROTECTS MOTOR HOUSING



TUNE-UP KIT CONTAINS SPARES NO.:
12, 20, 22, 31, 33, 36, 37



1993-VXL & 1993-1-VXL

1" x 7" | VIBROTHERM IMPACT WRENCH

MAX. TORQUE (NM)	LOOSENING TORQUE (NM)	SQUARE DRIVE (IN.)	IMPACTS PER MINUTE	SPEED (RPM)	BOLT CAPACITY (MM)	WEIGHT (KG)	LENGTH (MM)	LEVEL VIBRATION (SEC2)	AIR CONS. (CFM)	REC. HOSE SIZE (IN.)
2850	3120	1"x7"	950	6,000	32	9.16	473	12.7	10	1/2"
2850	3120	1"	950	6,000	32	8.3	340	12.7	10	1/2"



- NEW VIBRATION MECHANISM
- UNMATCHED POWER-TO-WEIGHT RATIO
- FRICTION-RING AND THROUGH-HOLE RETAINER



TUNE-UP KIT CONTAINS SPARES NO.:
04, 11, 14, 19, 27, 39, 46



NEW

1994 & 1994-1

1" X 8" | EXTENDED "SUPER DUTY" STRAIGHT IMPACT WRENCH

MAX. TORQUE (NM)	LOOSENING TORQUE (NM)	SQUARE DRIVE (IN.)	IMPACTS PER MINUTE	SPEED (RPM)	BOLT CAPACITY (MM)	WEIGHT (KG)	LENGTH (MM)	LEVEL VIBRATION (SEC2)	AIR CONS. (CFM)	REC. HOSE SIZE (IN.)
3120	3390	1"x8"	1100	4,500	25.4	15.8	660	12.0	12	1/2"
3120	3390	1"	1100	4,500	25.4	15	530	12.0	12	1/2"



- THE TRUCK TIRE REFERENCE
- MOST RELIABLE 1" IMPACT WRENCH
- TRIPLE-TREATED STEEL HAMMER CAGE AND ANVIL



TUNE-UP KIT CONTAINS SPARES NO.:
11, 17, 21, 32, 34, 35, 40

WHEN YOU HAVE REAL WORK TO DO...
GRAB AN **AIRCAT**.

IMPACT WRENCHES 1"



1997

1" X 8" | 1" SQ DRV IMPACT WRENCH (8" ANVIL) LIGHTWEIGHT

MAX. TORQUE (NM)	LOOSENING TORQUE (NM)	SQUARE DRIVE (IN.)	IMPACTS PER MINUTE	SPEED (RPM)	SCREW CAPACITY (MM)	WEIGHT (KG)	LENGTH (MM)	LEVEL VIBRATION (SEC2)	AIR CONS. (CFM)	REC. HOSE SIZE (IN.)
2441	2650	1"x8"	1600	6,000	25.4	7.5	547	6.6	10	1/2"



- HANDLE PROVIDES FULL CONTROL FOR THE OPERATOR
- LIGHTWEIGHT & POWERFUL
- BEST IN CLASS WITH ONLY 7.5 KG



TUNE-UP KIT CONTAINS SPARES NO.:
07, 10, 11, 13, 16, 27, 35



1997S

1" X 2" | 1" SQ DRV IMPACT WRENCH (2" ANVIL) LIGHTWEIGHT

MAX. TORQUE (NM)	LOOSENING TORQUE (NM)	SQUARE DRIVE (IN.)	IMPACTS PER MINUTE	SPEED (RPM)	SCREW CAPACITY (MM)	WEIGHT (KG)	LENGTH (MM)	LEVEL VIBRATION (SEC2)	AIR CONS. (CFM)	REC. HOSE SIZE (IN.)
2441	2650	1"x2"	1600	6,000	25.4	6.3	378	6.6	10	1/2"



- STRAIGHT REAR HANDLE
- SHORT ANVIL AVAILABLE
- BUILT FOR FLEET AND MAINTENANCE SERVICES



TUNE-UP KIT CONTAINS SPARES NO.:
07, 10, 11, 13, 16, 27, 35



1997-AH

1" X 8" | 1" IMPACT WRENCH (8" ANVIL) LIGHTWEIGHT

MAX. TORQUE (NM)	LOOSENING TORQUE (NM)	SQUARE DRIVE (IN.)	IMPACTS PER MINUTE	SPEED (RPM)	SCREW CAPACITY (MM)	WEIGHT (KG)	LENGTH (MM)	LEVEL VIBRATION (SEC2)	AIR CONS. (CFM)	REC. HOSE SIZE (IN.)
2441	2650	1"x8"	1600	6,000	25.4	7.5	492	6.6	10	1/2"



- CRANKED REAR HANDLE
- ROBUST ANVIL ENSURES DURABILITY
- HIGHLY EFFICIENT



TUNE-UP KIT CONTAINS SPARES NO.:
07, 10, 11, 13, 16, 27, 35



1997-AHS

1" X 2" | 1" IMPACT WRENCH (2" ANVIL) LIGHTWEIGHT

MAX. TORQUE (NM)	LOOSENING TORQUE (NM)	SQUARE DRIVE (IN.)	IMPACTS PER MINUTE	SPEED (RPM)	SCREW CAPACITY (MM)	WEIGHT (KG)	LENGTH (MM)	LEVEL VIBRATION (SEC2)	AIR CONS. (CFM)	REC. HOSE SIZE (IN.)
2441	2650	1"x2"	1600	6,000	25.4	6.5	324	6.6	10	1/2"



- LOW WEIGHT WITH EXCEPTIONAL POWER
- REDUCES FATIGUE AND STRAIN.
- ERGONOMIC BACK HANDLE FOR COMFORT, SHORT ANVIL.



TUNE-UP KIT CONTAINS SPARES NO.:
07, 10, 11, 13, 16, 27, 35



AC1997

IMPACT WRENCHES 1"



1600-TH-A1

1" | COMPOSITE IMPACT WRENCH

MAX. TORQUE (NM)	LOOSENING TORQUE (NM)	SQUARE DRIVE (IN.)	IMPACTS PER MINUTE	SPEED (RPM)	BOLT CAPACITY (MM)	WEIGHT (KG)	LENGTH (MM)	LEVEL VIBRATION (SEC2)	AIR CONS. (CFM)	REC. HOSE SIZE (IN.)
1900	2169	1"	1100	4,500	32	3.7	234	7.4	10	3/8"



- POWERFUL 'SUPER CLUTCH' TWIN HAMMER
- PATENTED FLIP LEVER FOR FORWARD/REVERSE
- IDEAL FOR GENERAL MAINTENANCE



TUNE-UP KIT CONTAINS SPARES NO.:
5, 7, 13, 16, 18, 20, 22, 23, 31, 32, 36, 38, 39



1870-P

1" | "SUPER DUTY" PISTOL LIGHTWEIGHT IMPACT WRENCH

MAX. TORQUE (NM)	LOOSENING TORQUE (NM)	SQUARE DRIVE (IN.)	IMPACTS PER MINUTE	SPEED (RPM)	BOLT CAPACITY (MM)	WEIGHT (KG)	LENGTH (MM)	LEVEL VIBRATION (SEC2)	AIR CONS. (CFM)	REC. HOSE SIZE (IN.)
2578	2850	1"	1400	7,500	32	5.8	271	8.6	7.5	1/2"



- LOW WEIGHT IMPACT-RESISTANT HOUSING
- CRANKED SIE HANDLE
- COMBINED FRICTION-RING AND THROUGH-HOLE RETAINERS



TUNE-UP KIT CONTAINS SPARES NO.:
03, 07, 13, 14, 19, 25, 27

DON'T BUY
A TOOL, BUY
THE TOOL



THE POWER OF AIRCAT

Now you know the power and quality of our impact wrenches.

If you want to find out more about each tool and its applications, scan the QR Code and visit our website!

