

REVISION

1	5547
2	5784
3	6163
4	
5	
6	
7	
8	
9	
10	
11	
12	
13	
14	
15	
16	
17	
18	
19	
20	

IMPORTANT

WHEN ORDERING SPARES YOU MUST STATE THE FULL PART NUMBER AND THE PRODUCT SERIAL NUMBER - FROM THE LABEL TO PROTECT YOUR WARRANTY ALWAYS USE GENUINE HI-FORCE PARTS.

ITEM NO.	PART NUMBER	DESCRIPTION	QTY.	SPARE PARTS	SERVICE PARTS
1	BLC006JD016	M6 x 16 HEX SOCKET CAP HEAD SCREW	2		
2	HA100	SADDLE	1		
3	SEC110XE001	WIPER	1		✓
4	SRC110SM001	STOP RING	1		
5	CBC140VD001	CYLINDER	1		
6	FFC004RC001	FILTER	1		
7	PPC1	DUST COVER	1		
8	CF1	COUPLER	1		
9	SFC195JB001	BASE PLATE	1		
10	BLC008KF016	M8 x 16 COUNTERSUNK SOCKET HEAD SCREW	4		
11	BLC008KD055	M8 x 55 HEX SOCKET CAP HEAD SCREW	2		
12	WAC008KD000	DOWTY WASHER	2		✓
13	BLC008KY016	STAINLESS STEEL M8 X 16 CAP HEAD SCREW	4		
14	HLC065AL001	HANDLE	2		
15	SPC063UE001	TENSION SPRING	1		
16	SIC015ED002	INSERT	2		
17	BSC140PD001	BEARING	2		
18	SEC140PA001	STEP SEAL	1		✓
19	PRC140YD001	PISTON	1		
20	BSC110PE001	BEARING	1		

REVISION

1 5547

2 5784

3 6163

4

5

6

7

8

9

10

11

12

13

14

15

16

17

18

19

20

NOTES:

- ALL PARTS ARE AVAILABLE TO BE ORDERED AS SPARE PARTS (UNLESS MARKED WITH x).

- ONLY PARTS MARKED WITH ✓ ARE AVAILABLE AS BOTH SPARE PARTS OR SERVICEABLE PARTS, FROM HAS100TP1-K SERVICE KIT. (REFER TO HAS100TP1-K EVD FOR FULL PARTS LIST)

IMPORTANT

WHEN ORDERING SPARES YOU MUST STATE THE FULL PART NUMBER AND THE PRODUCT SERIAL NUMBER - FROM THE LABEL TO PROTECT YOUR WARRANTY ALWAYS USE GENUINE HI-FORCE PARTS.

REVISION

1	6163
2	
3	
4	
5	
6	
7	
8	
9	
10	
11	
12	
13	
14	
15	
16	
17	
18	
19	
20	

ITEM NO.	PART NUMBER	DESCRIPTION	QTY.
1	SEC110XE001	WIPER	1
2	SEC140PA001	STEP SEAL	1
3	WAC008KD000	DOWTY WASHER	2

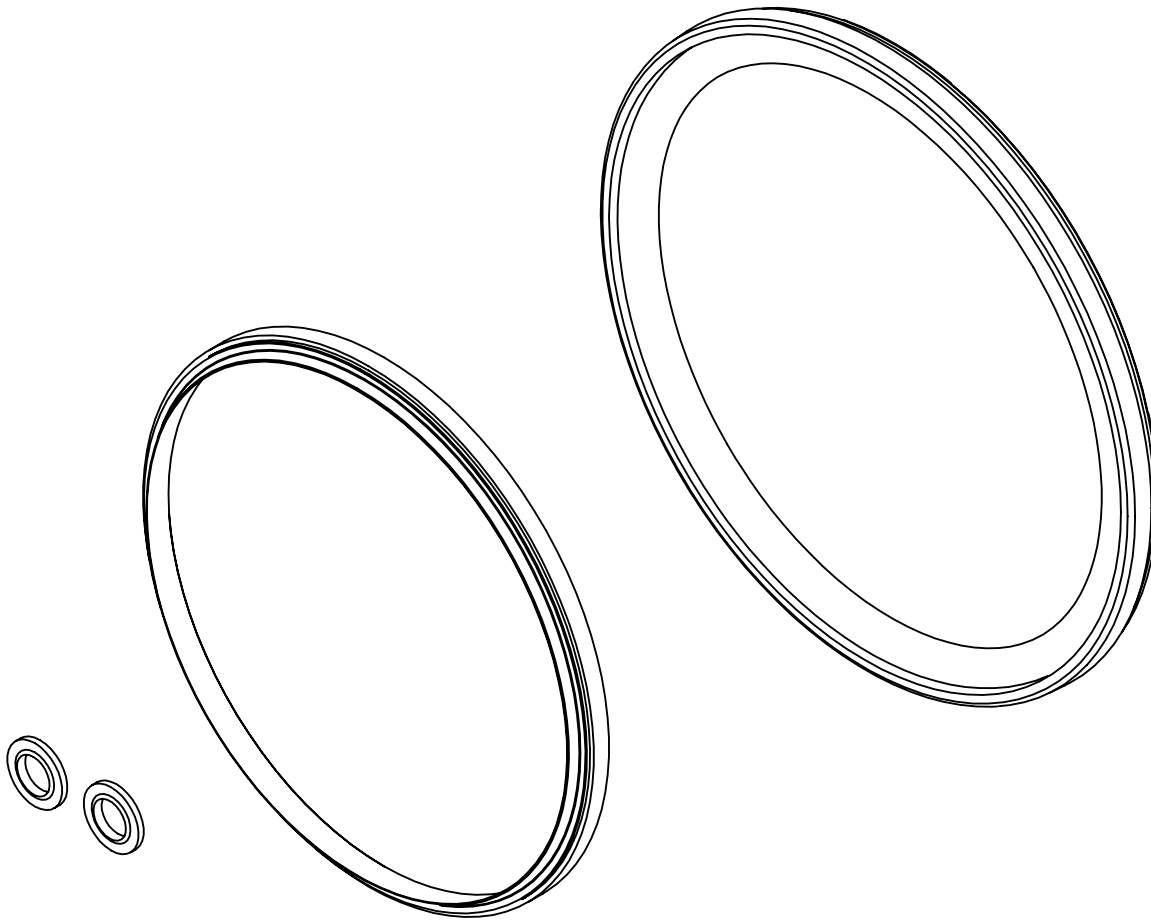

IMPORTANT
WHEN ORDERING SPARES YOU MUST STATE THE FULL PART NUMBER AND THE
PRODUCT SERIAL NUMBER - FROM THE LABEL
TO PROTECT YOUR WARRANTY ALWAYS USE GENUINE HI-FORCE PARTS.