

ITEM NO.	PART NUMBER	DESCRIPTION	QTY.	REVISION
1	ADC200ZA001	FRAME	1	1 6586
2	HDA2006	DOUBLE ACTING CYLINDER HDA2006	1	2
3	SAC140AT001	SADDLE ADAPTOR	1	3
4	SAC305AT001	FRAME SADDLE	1	4
5	FAS016MW003	ANTI-ROTATION ROD	1	5
6	SAC267ZC001	SADDLE ADAPTOR	1	6
7	SAC135WC001	SADDLE	1	7
8	BLC020PC035	M20 x 35 SOCKET CAP HEAD SCREW 12.9	4	8
9	FLC016CC001	M16 EYEBOLT	4	9
10	ADC200MC001	FRAME FOOT	4	10
11	BLC012MC050	M12 X 50mm, HEX SOCKET CAP HEAD SCREW	16	11
12	SIC018WG001	STUD	1	12
13	BLC012MF050	M12x50 HEX SKT CSK SCREW	1	13
14	BLC005HH016	M5 x 16 BUTTON HEAD SCREW	1	14

**NOTES:**

- ALL PARTS ARE AVAILABLE TO ORDER AS AN INDIVIDUAL SPARE PART.
- FOR HDA2006 SPARE PARTS - PLEASE REFER TO 'HDA2006 EVD'.
- FOR HCJ CLIMBING JACK SLF/SLV MOUNTING KIT AND DISPLACEMENT SENSOR, PLEASE REFER TO SHEET 2.

**IMPORTANT**

WHEN ORDERING SPARES YOU MUST STATE THE FULL PART NUMBER AND THE PRODUCT SERIAL NUMBER - FROM THE LABEL TO PROTECT YOUR WARRANTY ALWAYS USE GENUINE HI-FORCE PARTS.

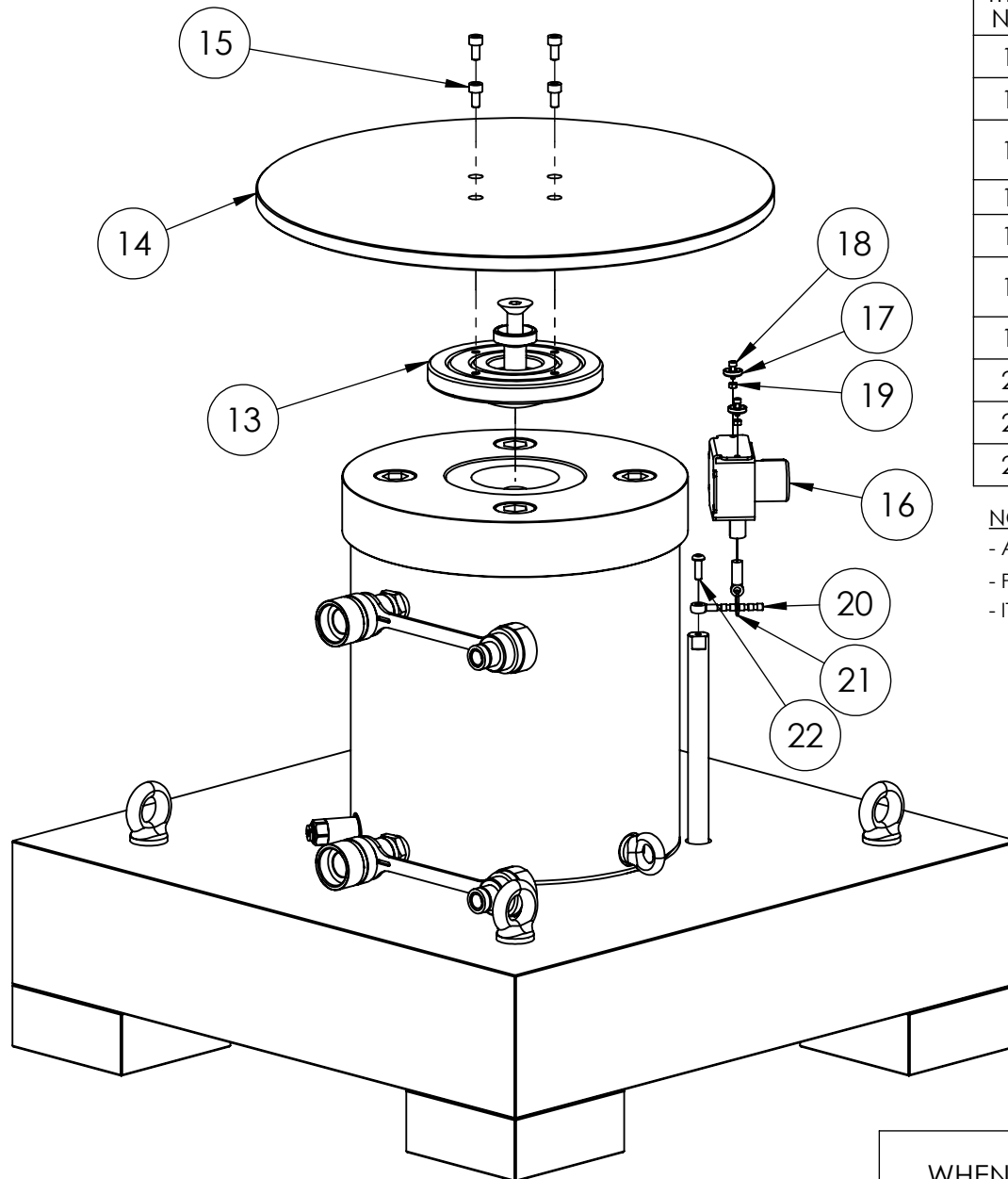

ITEM NO.	PART NUMBER	DESCRIPTION	QTY.	SLMK-34 PARTS	REVISION
13	SAC135WC003	SADDLE	1	✓	1 6586
14	SAC400EC001	SENSOR MOUNTING PLATE	1	✓	2
15	BLC006JC012	M6 x 12 SOCKET CAP HEAD SCREW	4	✓	3
16	SLDS650	DISPLACEMENT SENSOR	1		4
17	EMC000ZP003	SENSOR MAGNET	2	✓	5
18	BLC003ZD010	M3 x 10 HEX SOCKET CAP HD SCREW	2	✓	6
19	NUC003UA000	M3 FULL NUT (STAINLESS STEEL)	2	✓	7
20	SFC005RA001	SENSOR ROD	1	✓	8
21	STC020LA001	SENSOR RING	1	✓	9
22	BLC005HH016	M5 x 16 BUTTON HEAD SCREW	1	✓	10

**NOTES:**

- ALL PARTS ARE AVAILABLE TO ORDER AS AN INDIVIDUAL SPARE PART.
- PARTS MARKED WITH ✓ ARE AVAILABLE IN **SLMK-34** HCJ MOUNTING KIT.
- ITEM 16 (DISPLACEMENT SENSOR) IS ONLY AVAILABLE AS AN INDIVIDUAL PART '**SLDS650**'.

**IMPORTANT**

WHEN ORDERING SPARES YOU MUST STATE THE FULL PART NUMBER AND THE PRODUCT SERIAL NUMBER - FROM THE LABEL  
TO PROTECT YOUR WARRANTY ALWAYS USE GENUINE HI-FORCE PARTS.