

- ALL PARTS ARE AVAILABLE TO ORDER AS AN INDIVIDUAL SPARE PART.
- FOR HDA506 SPARE PARTS - PLEASE REFER TO 'HDA506 EVD'.
- FOR HCJ CLIMBING JACK SLF/SLV MOUNTING KIT AND DISPLACEMENT SENSOR, PLEASE REFER TO SHEET 2.

WHEN ORDERING SPARES YOU MUST STATE THE FULL PART NUMBER AND THE
PRODUCT SERIAL NUMBER - FROM THE LABEL
TO PROTECT YOUR WARRANTY ALWAYS USE GENUINE HI-FORCE PARTS.

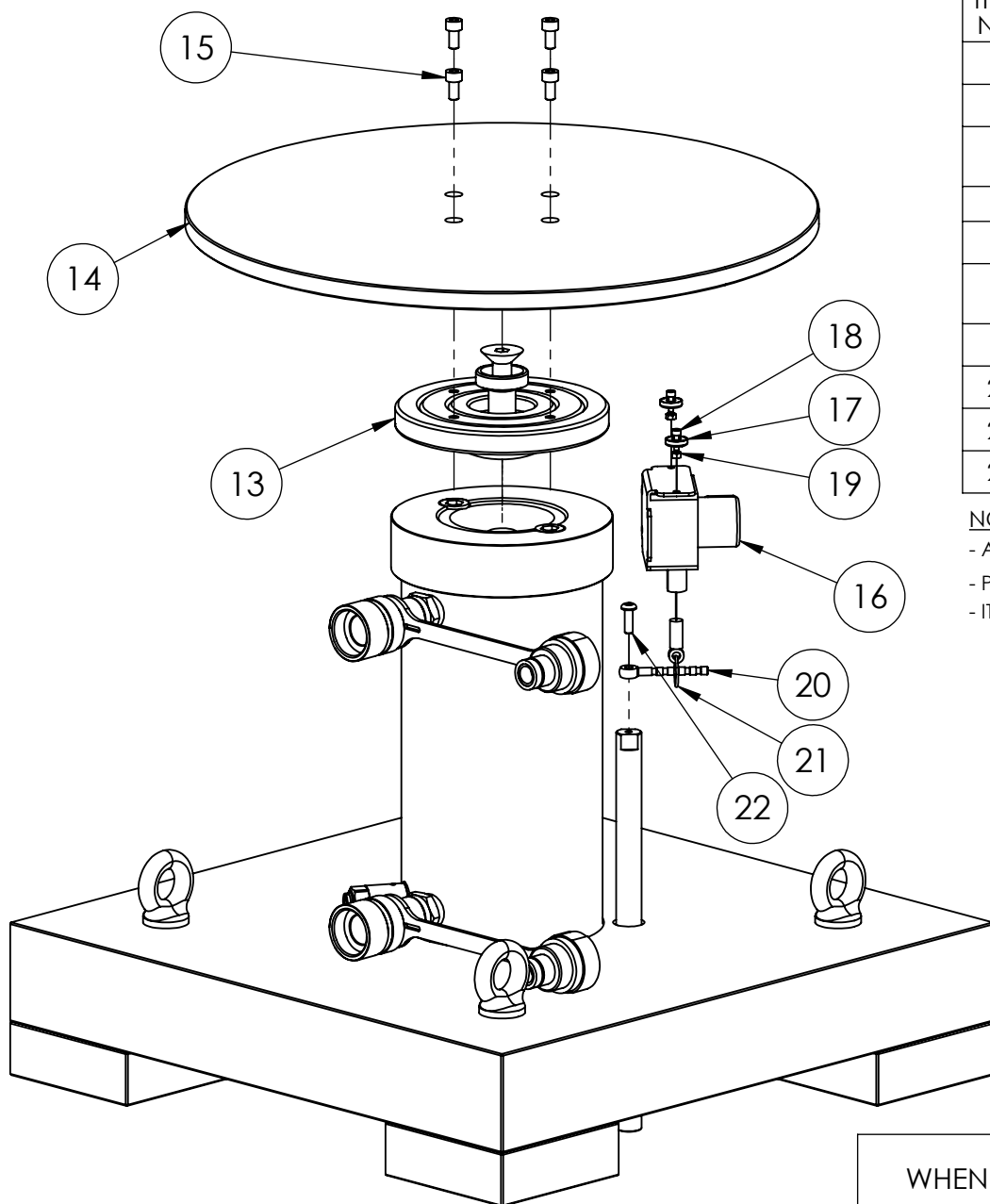

ITEM NO.	PART NUMBER	DESCRIPTION	QTY.	SLMK-34 PARTS	REVISION
13	SAC135WC003	SADDLE	1	✓	1 6586
14	SAC400EC001	SENSOR MOUNTING PLATE	1	✓	2
15	BLC006JC012	M6 x 12 SOCKET CAP HEAD SCREW	4	✓	3
16	SLDS650	DISPLACEMENT SENSOR	1		4
17	EMC000ZP003	SENSOR MAGNET	2	✓	5
18	BLC003ZD010	M3 x 10 HEX SOCKET CAP HD SCREW	2	✓	6
19	NUC003UA000	M3 FULL NUT (STAINLESS STEEL)	2	✓	7
20	SFC005RA001	SENSOR ROD	1	✓	8
21	STC020LA001	SENSOR RING	1	✓	9
22	BLC005HH016	M5 x 16 BUTTON HEAD SCREW	1	✓	10
					11
					12
					13
					14
					15
					16
					17
					18
					19
					20

NOTES:

- ALL PARTS ARE AVAILABLE TO ORDER AS AN INDIVIDUAL SPARE PART.
- PARTS MARKED WITH ✓ ARE AVAILABLE IN **SLMK-34** HCJ MOUNTING KIT.
- ITEM 16 (DISPLACEMENT SENSOR) IS ONLY AVAILABLE AS AN INDIVIDUAL PART 'SLDS650'.

IMPORTANT

WHEN ORDERING SPARES YOU MUST STATE THE FULL PART NUMBER AND THE PRODUCT SERIAL NUMBER - FROM THE LABEL TO PROTECT YOUR WARRANTY ALWAYS USE GENUINE HI-FORCE PARTS.