

Note: if the spring is replaced:
The inserts should also be replaced.

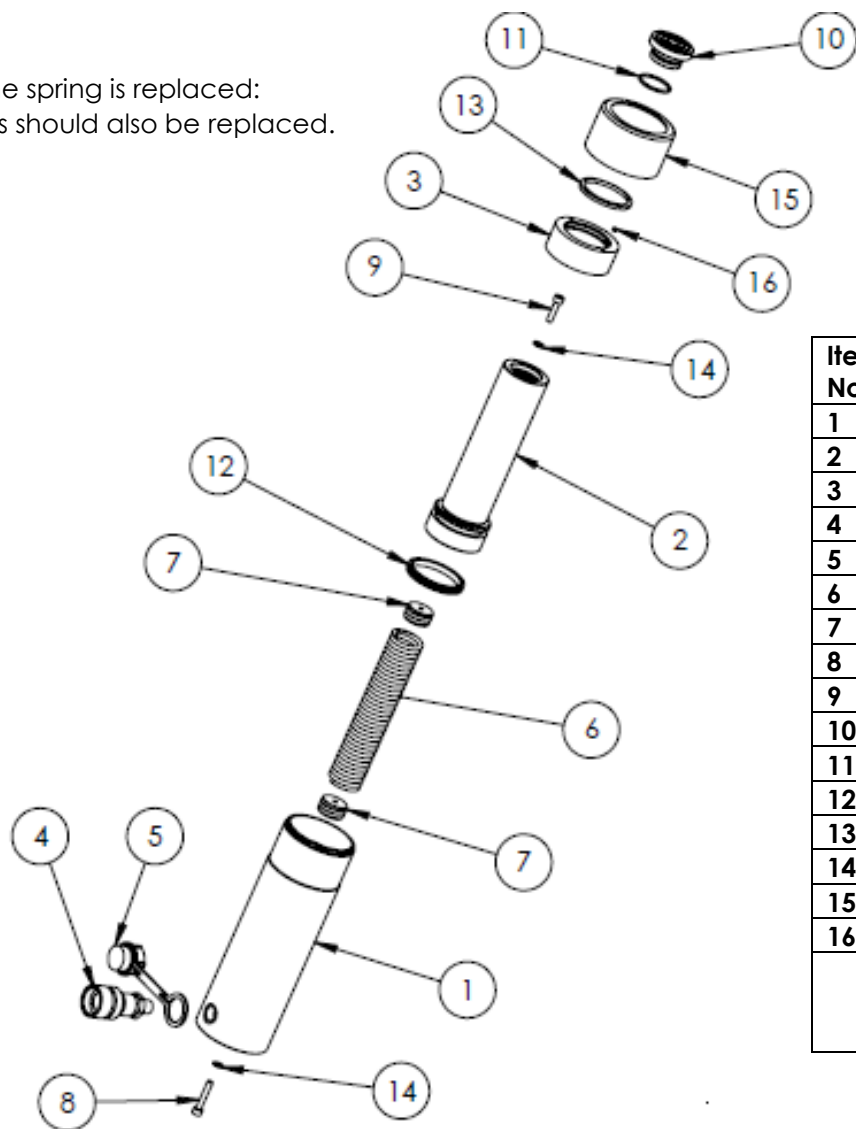

Item No	Description	Part Number	Qty:
1	CYLINDER	CBC067SJ001	1
2	PISTON	PRC067AJ001	1
3	STOP RING	SRC054SF003	1
4	FEMALE COUPLER	CF1	1
5	PLASTIC DUST CAP	PPC1	1
6	SPRING	SPC038TK001	1
7	SPRING INSERT	SIC029TCOO1	2
8	SOCKET HEAD CAP SCREW	BLC006JC035	1
9	SOCKET HEAD CAP SCREW	BLC006JD070	1
10	SADDLE	HA25	1
11	O-RING	X	1
12	PISTON SEAL	X	1
13	WIPER	X	1
14	WASHER	X	2
15	THREAD PROTECTOR	PTP086TP025	1
16	FILTER	FFC004RC001	1
	NOTE: ALL ITEMS MARKED 'X' ARE AVAILABLE IN SERVICE KIT HSS25TP2-K		

REVISION NO	
1	
2	
3	
4	
5	
6	
7	
8	
9	
10	
11	
12	
13	
14	
15	
16	
17	
18	
19	
20	

IMPORTANT

WHEN ORDERING SPARES YOU MUST STATE THE FULL PART NUMBER AND THE PRODUCT SERIAL NUMBER – FROM THE LABEL.
TO PROTECT YOUR WARRANTY ALWAYS USE GENUINE HI-FORCE PARTS.