

## MANIFOLDS



Working pressure 700 bar

Choice of open or controlled manifolds

2, 4, 6 or 8 outlet port models available

- Designed for easy control of the direction of flow of the hydraulic fluid within the system
- Available as open manifold blocks or with individual needle type shut off/throttle valves on each outlet

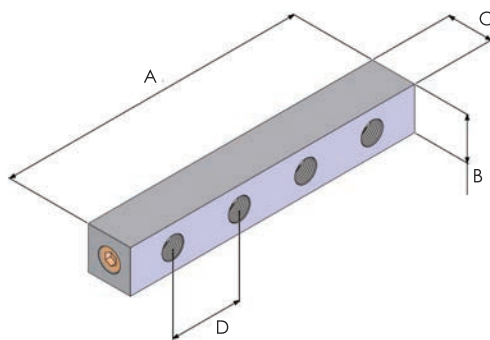

HM\* & HM\*L

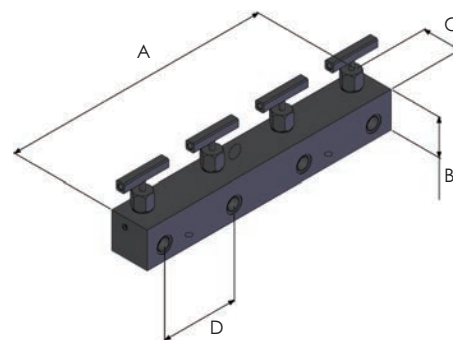

HM\*C

Model number	Type	Design	Number of outlets	Connection ports female threads		Weight (kg)	Dimensions (mm)			
				Inlet	Outlet		A	B	C	D
HM2	open manifold	parallel	2	$\frac{3}{8}$ " -18 NPT	2 x $\frac{3}{8}$ " -18 NPT	1.0	114	32	32	50
HM4	open manifold	parallel	4	$\frac{3}{8}$ " -18 NPT	4 x $\frac{3}{8}$ " -18 NPT	1.5	214	32	32	50
HM6	open manifold	parallel	6	$\frac{3}{8}$ " -18 NPT	6 x $\frac{3}{8}$ " -18 NPT	2.0	314	32	32	50
HM8	open manifold	parallel	8	$\frac{3}{8}$ " -18 NPT	8 x $\frac{3}{8}$ " -18 NPT	2.5	414	32	32	50
HM4L	open manifold	extended parallel	4	$\frac{3}{8}$ " -18 NPT	4 x $\frac{3}{8}$ " -18 NPT	2.4	394	32	32	110
HM6L	open manifold	extended parallel	6	$\frac{3}{8}$ " -18 NPT	6 x $\frac{3}{8}$ " -18 NPT	3.7	614	32	32	110
HM2C	controlled manifold	parallel	2	$\frac{3}{8}$ " -18 NPT	2 x $\frac{3}{8}$ " -18 NPT	2.0	150	51	38	100
HM4C	controlled manifold	parallel	4	$\frac{3}{8}$ " -18 NPT	4 x $\frac{3}{8}$ " -18 NPT	3.5	350	51	38	100