

REVISION

1	3933
2	4171
3	5277
4	5467
5	6212
6	
7	
8	
9	
10	
11	
12	
13	
14	
15	
16	
17	
18	
19	
20	

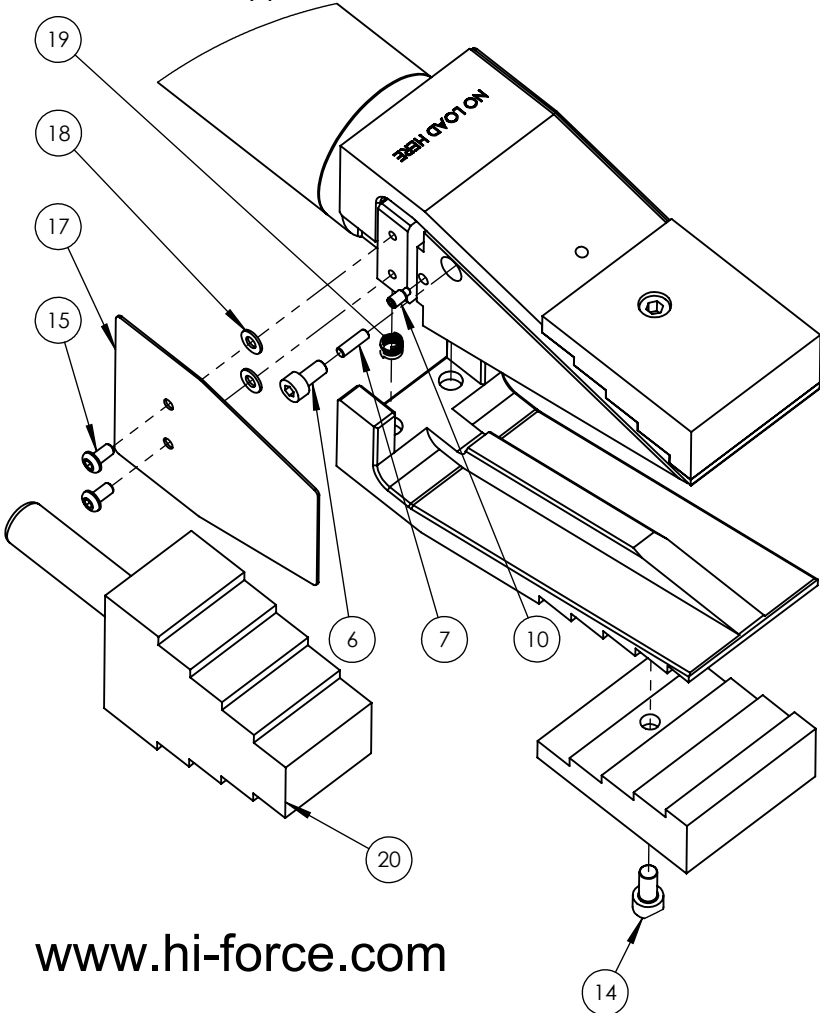
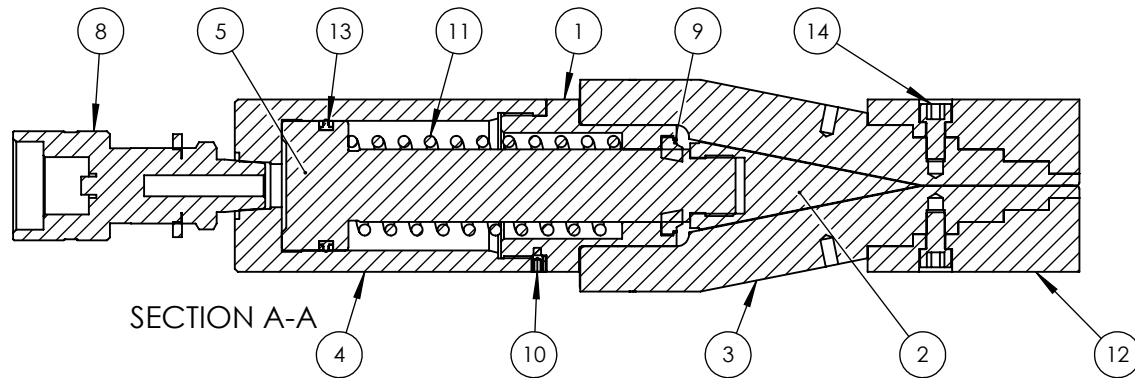
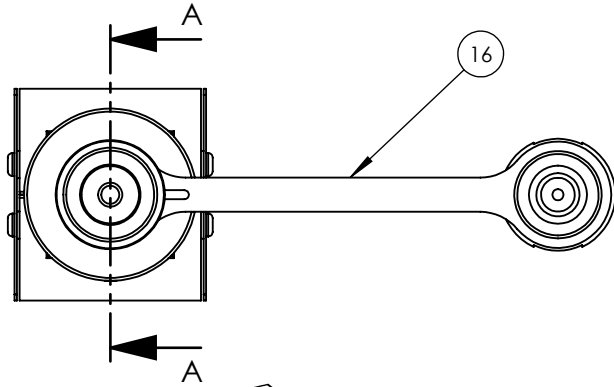

ITEM NO.	PART NUMBER	DESCRIPTION	QTY.	SPARE PARTS	SERVICE PARTS
1	SRC024WD001	STOP RING	1		
2	FSC010WS001	WEDGE	1		
3	FSC010JS001	JAW	2		
4	CBC043SC006	CYLINDER	1	x	
5	PRC043BC001	PISTON	1	x	
6	BLC005HD010	M5 x 10 HEX SOCKET CAP HEAD SCREW	2		
7	PCC004FC001	PIN	2		
8	CF1	COUPLER	1		
9	SEC024XE003	WIPER	1		✓
10	FAS004MD008	DOG POINT SCREW	2		
11	SPC033CC001	SPRING	1		
12	FSC010JS003	STEPPED BLOCK	2		
13	SEC043GA001	PISTON SEAL	1		✓
14	BLC006JC012	M6 x 12 SOCKET CAP HEAD SCREW	2		
15	BLC004-H008	M4 X 8mm, HEX SOCKET BUTTON HEAD SCREW	4		
16	PPC1	DUST COVER	1		
17	SFC070HB002	COVER PLATE	2		
18	WAC004JB000	TRAP SCREW WASHER	4		
19	SPC007CB003	COMPRESSION SPRING	4		
20	FSA010AS001	SAFETY BLOCK	1		

NOTE:

- ALL PARTS AVAILABLE TO BE ORDERED AS SPARE PARTS (UNLESS MARKED WITH X).
- ONLY PARTS MARKED WITH ✓ ARE AVAILABLE AS BOTH SPARE PARTS OR SERVICEABLE PARTS FROM SJS10TP2-K

IMPORTANT

WHEN ORDERING SPARES YOU MUST STATE THE FULL PART NUMBER AND THE PRODUCT SERIAL NUMBER - FROM THE LABEL TO PROTECT YOUR WARRANTY ALWAYS USE GENUINE HI-FORCE PARTS.

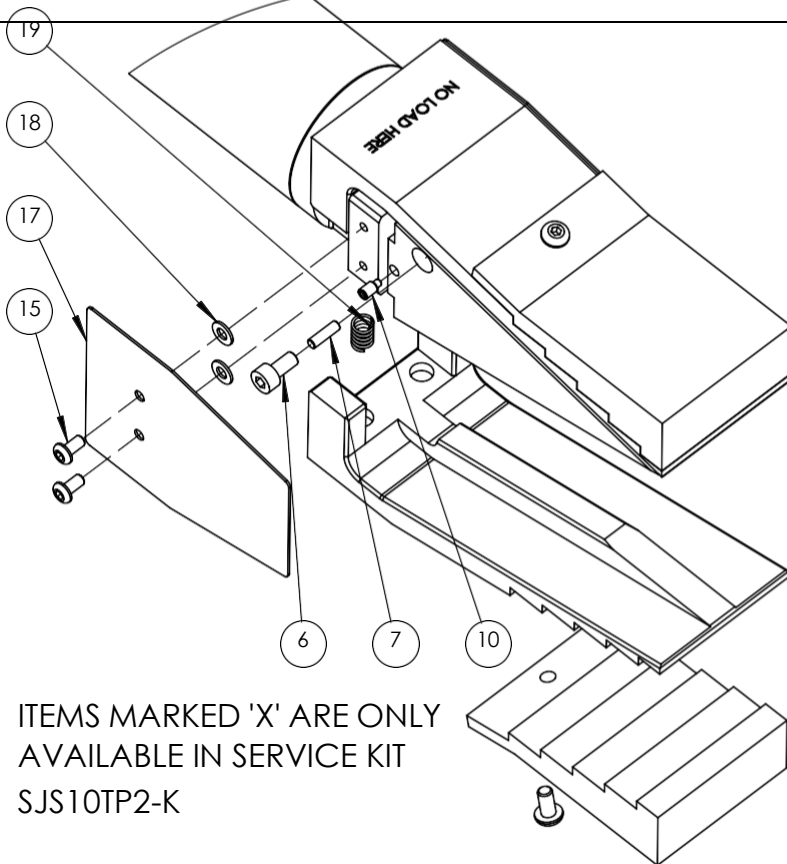
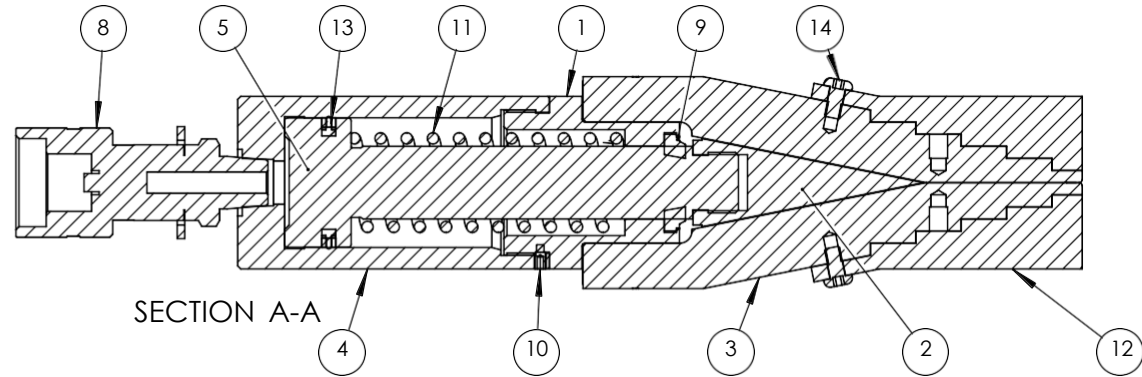
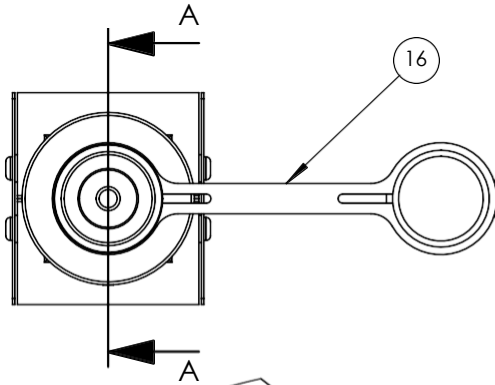

ITEMS MARKED 'X' ARE ONLY AVAILABLE IN SERVICE KIT SJS10TP2-K

ITEM NO.	PART NUMBER	DESCRIPTION	QTY.
1	SRC024WD001	STOP RING	1
2	FSC010WS001	WEDGE	1
3	FSC010JS001	JAW	2
4	CBC043SC006	CYLINDER	1
5	PRC043BC001	PISTON	1
6	X	SOCKET CAP HD SCREW	2
7	PCC004FC001	PIN	2
8	CF1	COUPLER	1
9	X	WIPER	1
10	X	M4 DOG POINT SCREW	2
11	SPC033CC001	SPRING	1
12	FSC010JS002	STEPPED BLOCK	2
13	X	PISTON SEAL	1
14	X	BUTTON HEAD SCREW	2
15	X	BUTTON HEAD SCREW	4
16	PPC1	DUST COVER	1
17	SFC070HB002	COVER PLATE	2
18	X	TRAP SCREW WASHER	4
19	SPC007CA002	SPRING	4

REVISION

1	3933
2	4171
3	5277
4	5467
5	
6	
7	
8	
9	
10	
11	
12	
13	
14	
15	
16	
17	
18	
19	
20	

IMPORTANT

WHEN ORDERING SPARES YOU MUST STATE THE FULL PART NUMBER AND THE PRODUCT SERIAL NUMBER - FROM THE LABEL TO PROTECT YOUR WARRANTY ALWAYS USE GENUINE HI-FORCE PARTS.

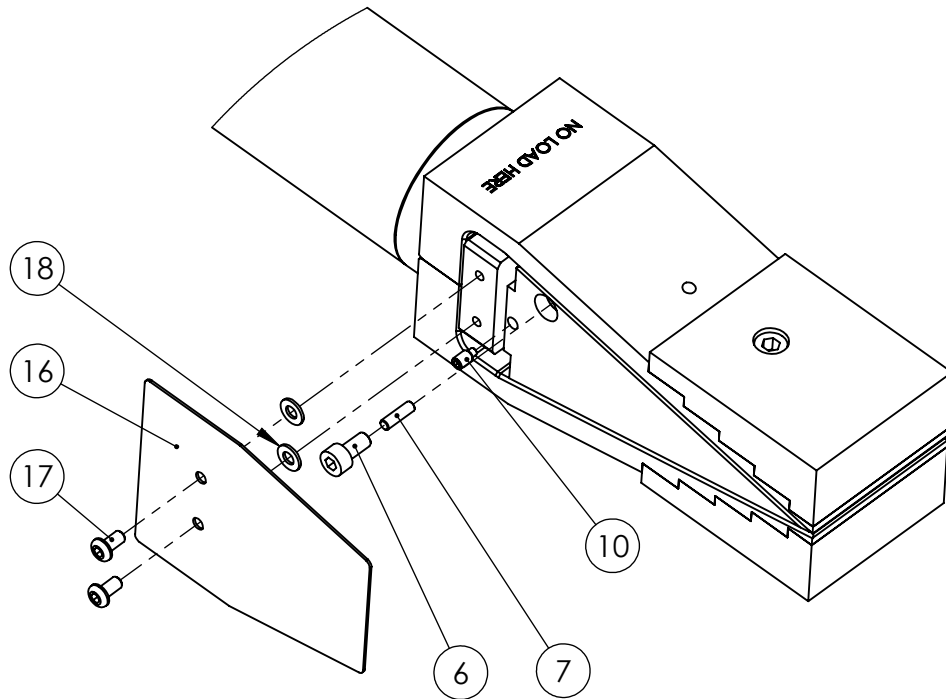
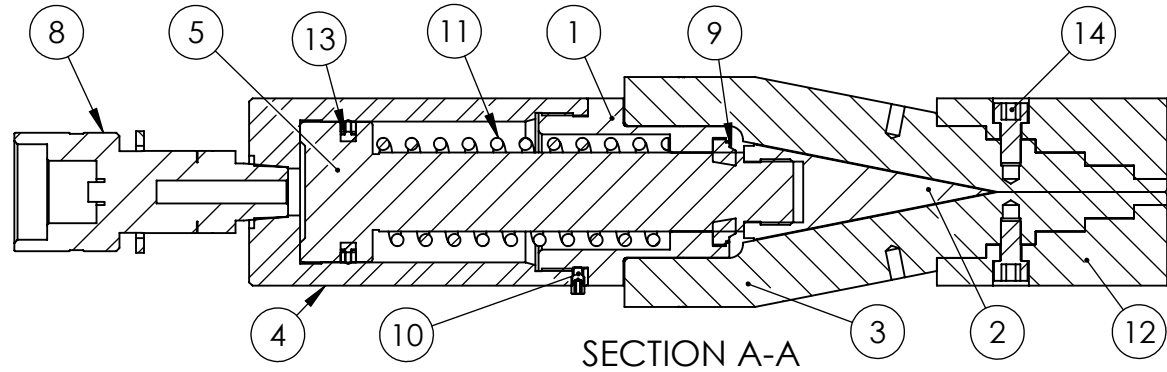
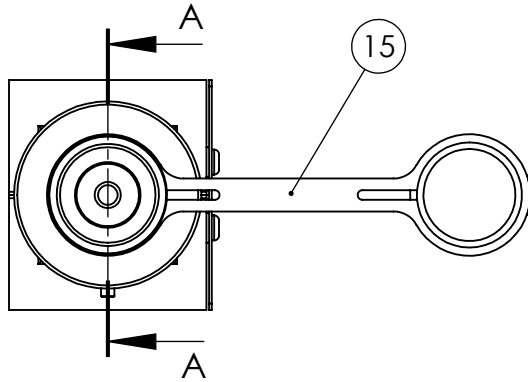

ITEMS MARKED X ARE ONLY
AVAILABLE IN SERVICE KIT
SJS10TP1-K

ITEM NO.	PART NUMBER	DESCRIPTION	QTY.
1	SRC024WD001	STOP RING	1
2	FSC010WS001	WEDGE	1
3	FSC010JS001	JAW	2
4	CBC043SC006	CYLINDER	1
5	PRC043BC001	PISTON	1
6	X	SOCKET CAP HD SCREW	2
7	PCC004FC001	PIN	2
8	CF1	COUPLER	1
9	X	WIPER	1
10	X	DOG POINT SCREW	2
11	SPC033CC001	SPRING	1
12	FSC010JS003	STEPPED BLOCK	2
13	X	PISTON SEAL	1
14	X	SOCKET CAP HD SCREW	2
15	PPC1	DUST COVER	1
16	SFC070HB002	COVER PLATE	2
17	X	BUTTON HEAD SCREW	4
18	X	TRAP SCREW WASHER	4

REVISION

1	
2	3933
3	4171
4	5277
5	
6	
7	
8	
9	
10	
11	
12	
13	
14	
15	
16	
17	
18	
19	
20	

IMPORTANT

WHEN ORDERING SPARES YOU MUST STATE THE FULL PART NUMBER AND THE
PRODUCT SERIAL NUMBER - FROM THE LABEL
TO PROTECT YOUR WARRANTY ALWAYS USE GENUINE HI-FORCE PARTS.

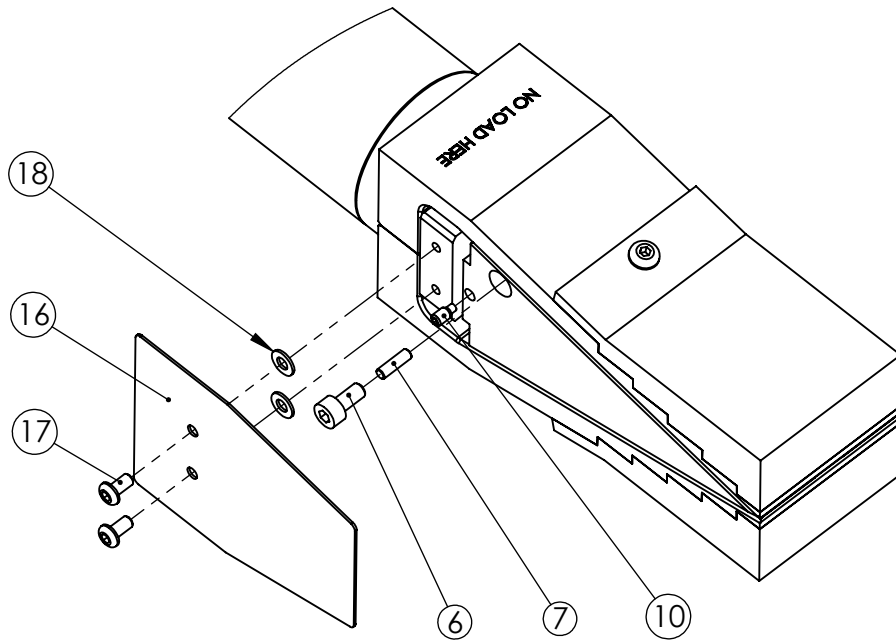
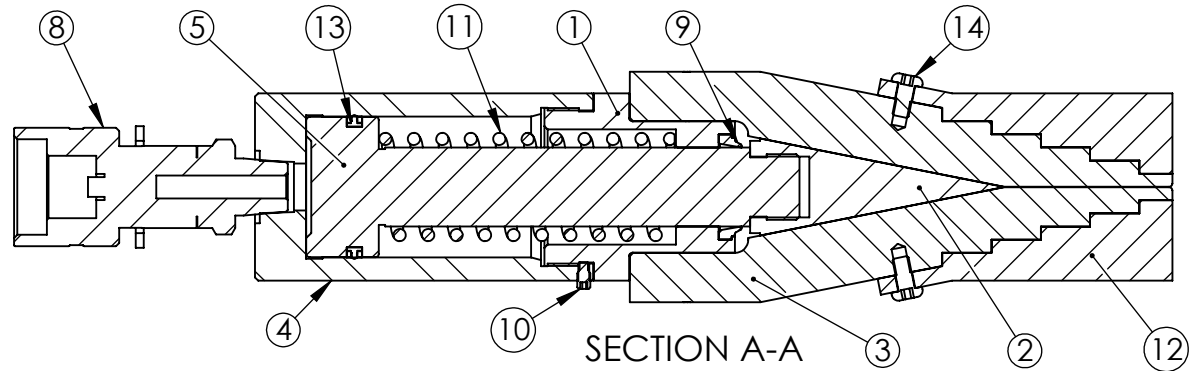
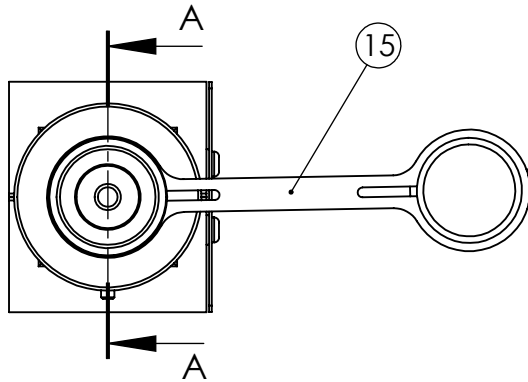

ITEMS MARKED X ARE ONLY
AVAILABLE IN SERVICE KIT
SJS10TP1-K

ITEM NO.	PART NUMBER	DESCRIPTION	QTY.
1	SRC024WD001	STOP RING	1
2	FSC010WS001	WEDGE	1
3	FSC010JS001	JAW	2
4	CBC043SC006	CYLINDER	1
5	PRC043BC001	PISTON	1
6	x	SOCKET CAP HD SCREW	2
7	x	PIN	2
8	CF1	COUPLER	1
9	x	WIPER	1
10	x	DOG POINT SCREW	2
11	SPC033CC001	SPRING	1
12	FSC010JS002	STEPPED BLOCK	2
13	x	PISTON SEAL	1
14	x	BUTTON HEAD SCREW	2
15	PPC1	DUST COVER	1
16	SFC070HB002	COVER PLATE	2
17	x	BUTTON HEAD SCREW	4
18	x	TRAP SCREW WASHER	4

IMPORTANT

WHEN ORDERING SPARES YOU MUST STATE THE FULL PART NUMBER AND THE PRODUCT SERIAL NUMBER - FROM THE LABEL TO PROTECT YOUR WARRANTY ALWAYS USE GENUINE HI-FORCE PARTS.

REVISION

1 3933

2

3

4

5

6

7

8

9

10

11

12

13

14

15

16

17

18

19

20